

THIS DRAWING IS AN UNCONTROLLED COPY UNLESS STAMPED OTHERWISE
 CONTRACTORS SHALL VERIFY JOB DIMENSIONS BEFORE ANY JOB COMMENCES.
 ALL SHOP DRAWINGS SHALL BE SUBMITTED TO THE SUPERINTENDENT AND MANUFACTURE
 SHALL NOT COMMENCE WORK TO THE RETURN OF FINISHED SHOP DRAWINGS ISSUED
 BY THE CONSULTANT. FINISHED DIMENSIONS SHALL TAKE PRECEDENCE OVER SCALED. THIS
 DRAWING SHOULD BE READ IN CONJUNCTION WITH ALL RELEVANT CONTRACT SPECIFICATIONS
 AND DRAWING COPYRIGHT OF THIS DRAWING IS VESTED IN INVOLVE

General Notes
 01. SEE MESH ENGINEER DRAWINGS FOR ALL SS MESH AND CABLE CONNECTION
 DETAILS, INCLUDING CLAMPS, BRACKETS, TURN BUCKLES STUDS CLEATS
 ANCHORS AND ENDSTOPS.
 02. SEE STRUCTURAL FOR ALL CONNECTIONS TO CONCRETE POCKETS

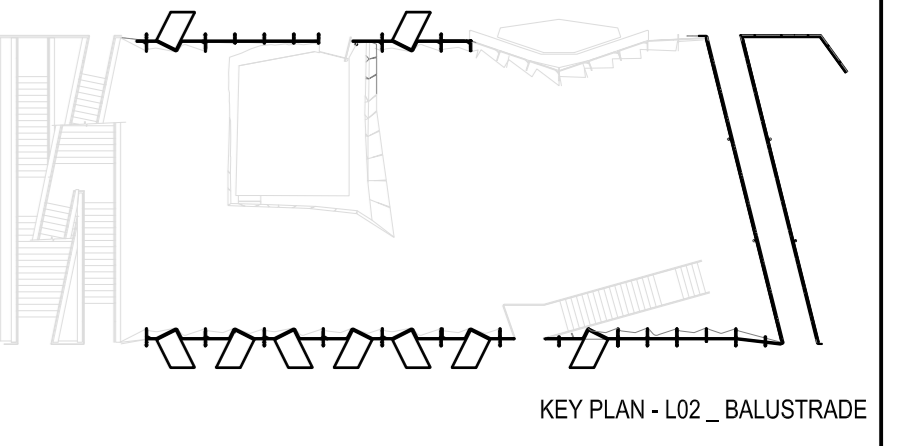

Rev	Issue	Revision Description	Amtd	Date
A	JC	CONSTRUCTION ISSUE	-	24.01.14
06	JC	100% CD - TENDER RE-ISSUE	-	10.08.13
05	JC	100% CD - TENDER RE-ISSUE	-	11.08.12
04	JC	100% CD - TENDER ISSUE	-	07.08.12
03	JC	90% CD ISSUE	-	10.08.12
02	JC	75% CD ISSUE	-	13.07.12
01	JC	50% CD ISSUE	-	01.08.12

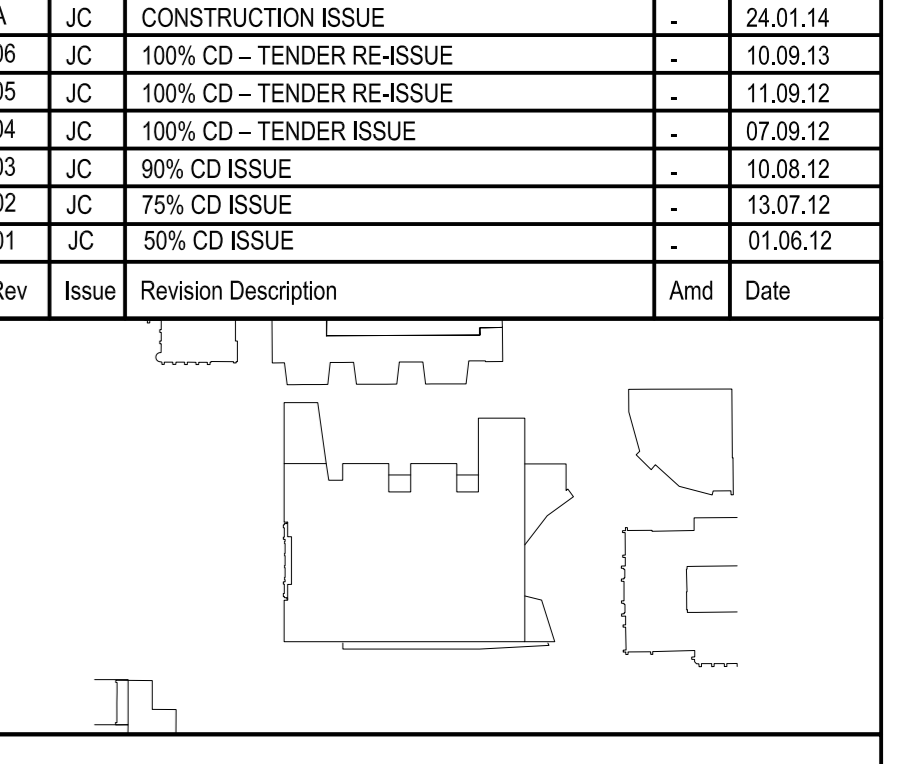

NADAAA
 NADAAA
 1302 Washington Street No.2
 Boston Massachusetts
 02118 USA
 Telephone +1 617 442 9232
 Facsimile +1 617 442 1417
 Email nads@nadaaa.com
 nads@nadaaa.com

John Wardle Architects
 © 2011 John Wardle Architects
 Level 10, 180 Russell Street, Melbourne Victoria 3000 Australia
 Tel: +613 9654 8700 www.johnwardlearchitects.com

Client **University of Melbourne Parkville Campus**

Project **Faculty of Architecture Building and Planning**

Title **MESH BALUSTRADE LEVEL 02 TYPICAL**

Project No. **0913** Scale AS NOTED
 Drawing No. **AR5051** Revision **A**

Date JAN 2014 Dwn - Co-Ord - Chk -
 FILENAME - ###

FOR CONSTRUCTION